

# YORK TOWNSHIP SECTION 19 R 13 TWP 10 MORGAN COUNTY, OHIO

PIN	Owner	LegalDescr	Acres	VOL	PAGE	Survey_Ref
190-000-780-0	CHERRY LLC	R13 T10 S10 SD 4	0.35	OR211	2699	YRK-0280.pdf
190-000-730-0	CHERRY LLC	R13 T10 S19 SD 16	2.25	OR211	2699	NoSurvey.pdf
190-000-750-0	CHERRY LLC	R13 T10 S19 SD 25	6	OR221	2699	NoSurvey.pdf
190-000-170-0	CHERRY LLC	R13 T10 S19 SD 21	4	OR211	2699	NoSurvey.pdf
190-000-740-0	CHERRY LLC	R13 T10 S19 SD 23	22.4	OR221	2699	NoSurvey.pdf
190-000-720-0	CHERRY LLC	R13 T10 S19 SD 8	71.113	OR221	2699	NoSurvey.pdf
190-000-760-0	CHERRY LLC	R13 T10 S19 SD 2	81.34	OR211	2699	NoSurvey.pdf
190-000-770-0	CHERRY LLC	R13 T10 S19 SD 3	65.25	OR211	2699	NoSurvey.pdf
190-000-720-1	CHERRY NEIL D & FAYE	R13 T19 S19 SD 28 SUR	4.331	OR228	1150	YRK-0108.pdf
190-000-720-2	CHERRY WALTER M TR	R13 T10 S19 SD 29	0.656	OR166	733	YRK-0108.pdf
190-000-710-0	CHERRY WALTER M TR	R13 T10 S19 SD 19 EX	12	OR178	116	NoSurvey.pdf
190-600-110-0	CHURCH (LUTHERAN CH	R13 T10 S00 LOT 19	1	OR222	2460	NoSurvey.pdf
190-001-220-0	DALZELL JAMES S & JU	R13 T10 S19 SD 24 EX	0.4	OR189	453	NoSurvey.pdf
190-001-230-0	DALZELL JAMES S & JU	R13 T10 S19 SD 20 EX	5	OR189	453	NoSurvey.pdf
190-001-210-0	DALZELL JAMES S & JU	R13 T10 S19 SD 1 EX C	53.6	OR189	453	NoSurvey.pdf
190-001-720-0	FISHER BRIAN E & JENNI	R13 T10 S19 SD 22 SUR	54.429	OR214	3007	YRK-0275.pdf
190-001-760-0	FISHER MICHAEL D	R13 T10 S19 SD 4	0.28	OR211	577	YRK-0191.pdf
190-001-750-1	FISHER MICHAEL D	R13 T10 S19 SD 30	6.23	OR211	577	YRK-0191.pdf
190-001-730-2	FISHER RONNIE D & LORI	R13 T10 S19 SD 31 SUR	57.923	OR203	1979	NoSurvey.pdf
190-001-730-1	FISHER RONNIE D & LORI	R13 T10 S19 SD 27 SUR	1.55	OR191	777	YRK-0070.pdf
190-001-750-0	FISHER RUSSELL L & BE	R13 T10 S19 SD 9-11 S	47.15	OR146	815	NoSurvey.pdf
190-005-010-0	STONEBURNER BARBA	R13 T10 S19 SD 13 EX	6.746	OR222	502	YRK-0282.pdf
190-004-920-0	STONEBURNER SEAN A	R13 T10 S19 SD 10-12	51.176	OR162	227	YRK-0292.pdf
190-001-720-1	STORTS JERRY & CAND	R13 T10 S19 SD 32 SUR	1.634	OR206	307	YRK-0278.pdf
190-004-990-0	STORTS JERRY A & CA	R13 T10 S19 SD 14 EX	16	OR200	574	NoSurvey.pdf
190-005-000-0	STORTS JERRY A & CA	R13 T10 S19 SD 7 SUR	24	OR200	574	NoSurvey.pdf
190-004-950-0	SULLIVAN TRAVIS JAS	R13 T10 S19 SD 5	53.37	OR234	3806	https://onedrive

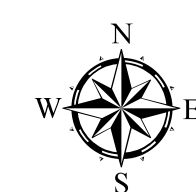

Boundaries	
	Hydro
	Section
	Roads
	Lot
	Township
	County
	Parcel
	ROW

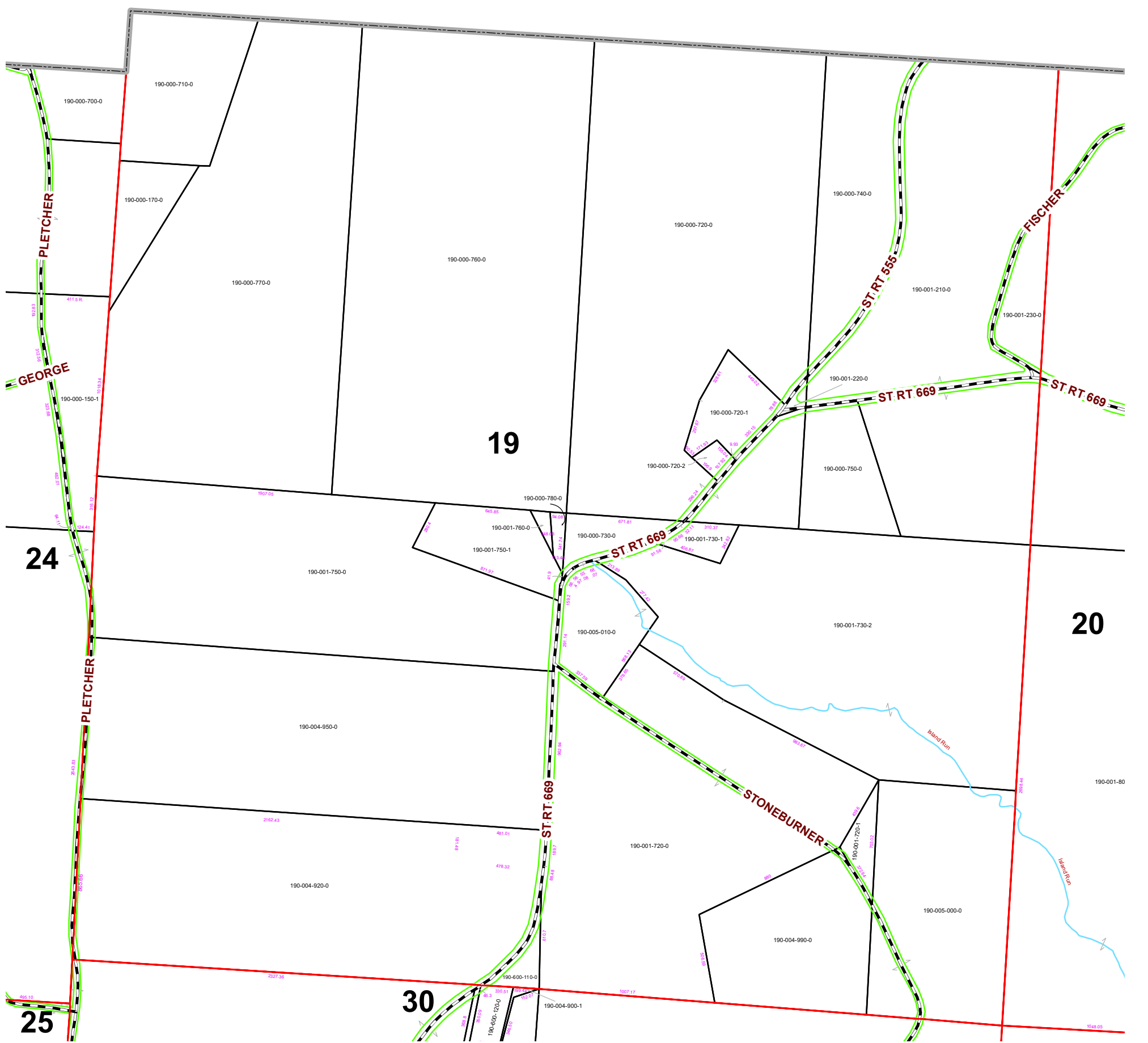

Disclaimer: The information that these maps contains is for reference purposes only. Please bring any erros to the attention of the Engineer's Office staff. Thank you

Source: Morgan County Engineer's Office  
 Author: Marcia Wolfe  
 Date: 02/10/20

